

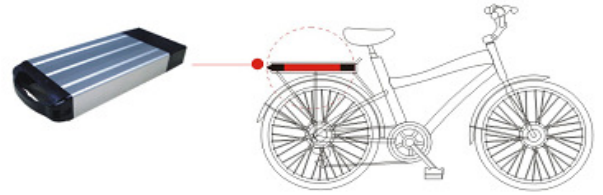

**Battery Kit 24V 9Ah Li-Ion  
+ Charger for Ebike**



**CARACTERISTIQUES ELECTRIQUES  
ELECTRICAL CHARACTERISTICS**

<b>Cell Brand</b>	Panasonic
<b>Cell Code</b>	IFP287194S10A
<b>Chemistry</b>	CGR18650CG
<b>Voltage</b>	24 V
<b>Capacity</b>	9 Ah
<b>Rate</b>	216 Wh
<b>Configuration</b>	7S4P
<b>Inner Resistance</b>	≤75 mΩ
<b>Limit</b>	29.75V
<b>Continuous Discharge Current</b>	13 A
<b>Burst Discharge Current</b>	30 A
<b>Operate Temp. Charge</b>	0~45 °C
<b>Operate Temp. Discharge</b>	-20~60 °C
<b>Storage Temp.</b>	-20~40 °C
<b>Cycle Life</b>	500 Times
<b>PCB SAFETY protection</b>	Over-discharge
	Over-current protection
	Over-charge
	Secondary protection

**CARACTERISTIQUES PHYSIQUES  
PHYSICAL CHARACTERISTICS**

Accumulateur / Battery	
<b>Dimension (mm)</b>	291 x 150 x 53 (+/- 1)
<b>Poids / Weight (g.)</b>	2190

**Accessories include :**



Size: 115.15 x 58.90 x 31.30 mm  
 Input Voltage: 100-240 V  
 Output Voltage: 42.3 V  
 Output Current: 1.35 A  
 Cord Length: 1000 mm

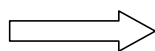

Size: 66.00 x 52.00 x 149.00 mm  
 Length: 1500 mm

## Features :

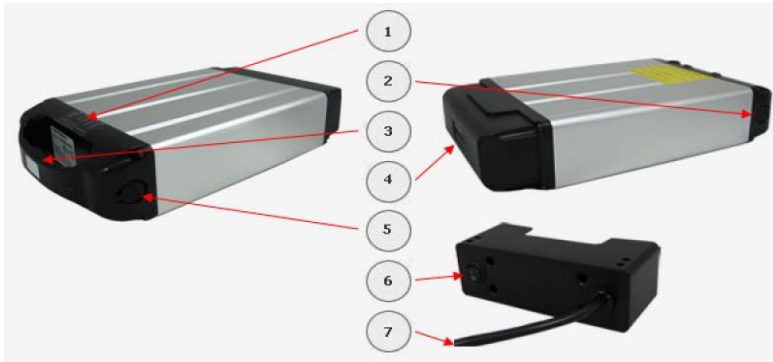

1	4-Level LED indicator	4 Led indicateur de charge
2	15A Fuse	Fusible 15A
3	Handlebar	Poignet
4	Battery contact socket	Prise batterie
5	Charging input jack	Prise jack pour recharger la batterie
6	Power on/off	Bouton marche/arret
7	Connecting cable	Cable de connexion



The Four-level LED indicates current power status



Not much space is needed to install the portable battery into the rear carrier.



The 15A fuse, serves as a second protection device, can prevent the battery pack from excessive discharge.



Battery can be recharged either by fastening on the bike or by itself with the provided AC adapter.



The power on/off button is set on the battery base.