



LITHIUM BATTERY

PILE LITHIUM

MAIN INFORMATION / INFORMATIONS GÉNÉRALES

SIZE	FORMAT	CR2
BRAND	MARQUE	NX
TECHNOLOGY	TECHNOLOGIE	Lithium
NOMINAL VOLTAGE	TENSION NOMINALE	3V
NOMINAL CAPACITY	CAPACITÉ NOMINALE	1000mAh
MAX. CONSTANT CURRENT OF DISCHARGE	COURANT DE DÉCHARGE CONTINU MAXIMUM	800mAh
MAX. PULSE DISCHARGE CURRENT	COURANT PULSE MAXIMUM	1500mAh
OPERATING TEMPERATURE RANGE	PLAGE DE TEMPÉRATURE DE FONCTIONNEMENT	-40°C / +70°C
DIMENSIONS	DIMENSIONS	
• Length / Longueur		27.0mm
• Diameter / Diamètre		15.5mm
WEIGHT	POIDS	11g

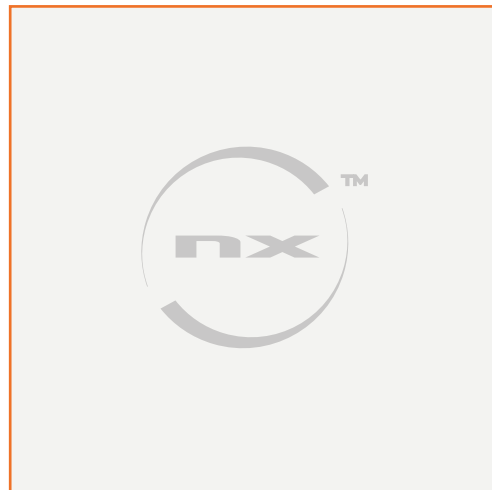

DIFFERENT CURRENT DISCHARGE CURVES (25°C)

DIFFÉRENTES COURBES DE DÉCHARGE DE COURANT

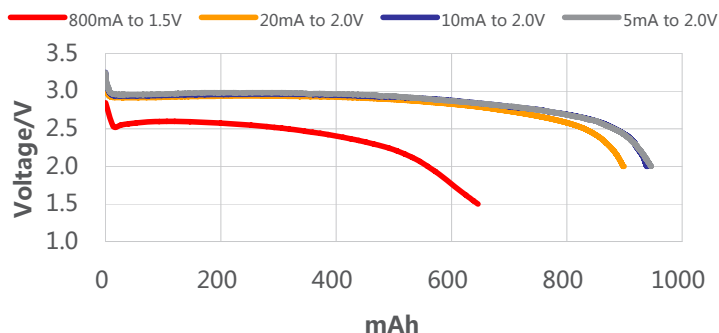

M6-F / Terminal

Unité : mm / Unit: inches

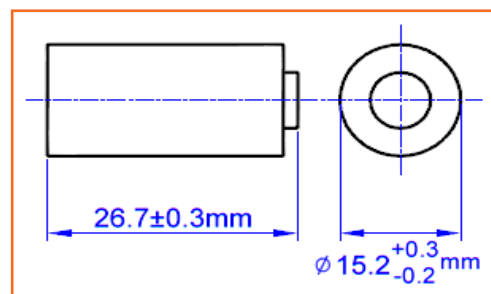

DIFFERENT TEMPERATURE DISCHARGE CURVES (0.9A 3sec.on/27sec.off)

COURBES DE DÉCHARGE À DIFFÉRENTES TEMPÉRATURES

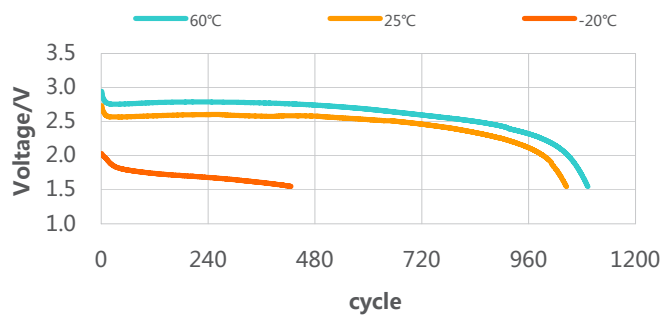

DIFFERENT TEMPERATURE DISCHARGE CURVES (20mAh to 2.0V)

COURBES DE DÉCHARGE À DIFFÉRENTES TEMPÉRATURES

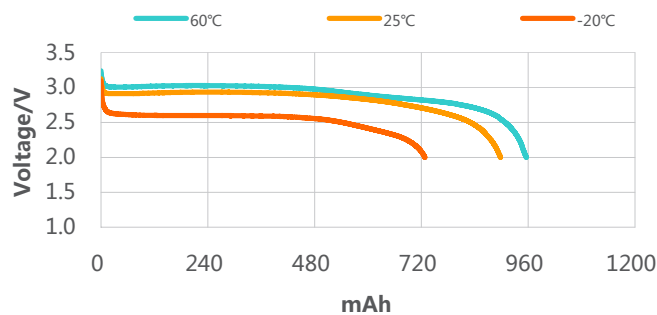

DISCHARGE CURVES (20mAh to 2.0V)
COURBES DE DÉCHARGE

